

# Z4.205

## Specifications

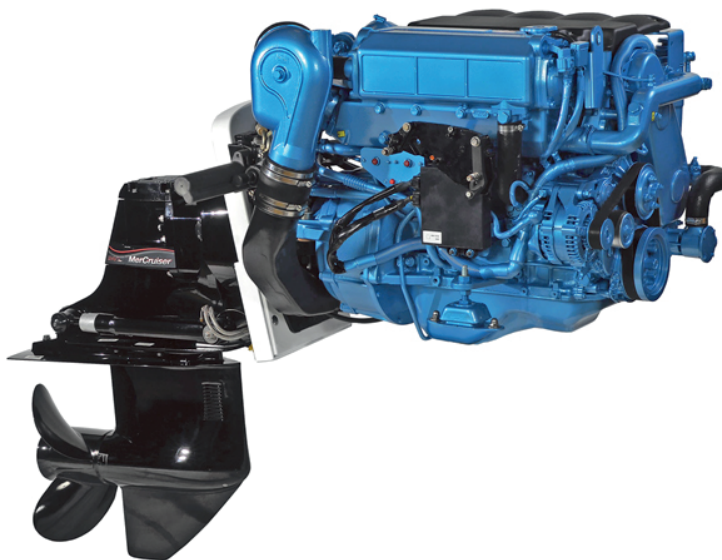

Power at crankshaft	147.2 kW [200 hp]
Displacement	2.982 l [182 in <sup>3</sup> ]
Configuration	4 cylinders in line
Operation type	4 stroke Diesel
Bore & Stroke	96 x 103 mm [3.78 x 4.06 in]
Compression ratio	15:1
Rated speed	3600 rpm
Idling speed	700 rpm
Peak torque	506.1 Nm
Peak torque speed	2000 rpm
Dry weight	
with Bravo X Two	472 kg [1040 lbs]

Engine base	Toyota
Fuel system	Direct injection High pressure Common Rail Electronically controlled
Air intake	Turbocharged with intercooler
Cooling	Closed cooling with heat exchanger
Max mounting angle	7° Front up 7° Front down
Alternator	12 Volt 100 Amp
Rating	M6
Emission compliance	IMO Annex VI compliant RCD 2013/53/EU EPA marine Tier 3 BSO 2

# Z4.205

147.2 kW [200 hp] at 3600 rpm

## TECHNICAL DESCRIPTION

### Engine block

- 4 cylinders in line
- 4 valves per cylinder
- Dual overhead camshafts (DOHC)
- Watercooled exhaust manifold
- Internal balancers

### Fuel system

- Common Rail fuel injection system
- Fuel filter with hand primer
- Integrated fuel cooler

### Lubrication system

- Replaceable full-flow oil filter
- Oil dipstick
- Transmission oil cooler

### Cooling system

- Closed cooling with heat exchanger
- Gear driven self-priming raw water pump
- Coolant circulating pump
- Water cooled exhaust elbow

### Electrical system & Instrumentation

- 12V 100A alternator
- 12V Electrical system
- Complete instrumentation including key switch and alarms
- Extension cable harness with plug-in connection

### Air intake

- Dry turbocharger
- Intercooler

### Other features

- Flexible engine mounting
- Transom (Trim system, Bull Horn and Mercathode)
- Trim indicator

### Optional equipment & accessories

- Throttle and shift controls
- Additional instrumentation, Flying bridge extension harness
- Water boiler systems
- Complete fuel systems
- Complete exhaust systems

## RATING

- Up to 500 annual operating hours
- Load factor up to 35%
- Full power for no more than 30 minutes out of each 8 hours of operation. The remaining operation time must be at or below cruising speed

## TRANSMISSIONS

### Stern Drive

- Bravo X One
- Bravo X Three
- Bravo X Two

Contact your local dealer for more details and availability for transmission model and type.

## PERFORMANCE CURVES

### Power at crankshaft

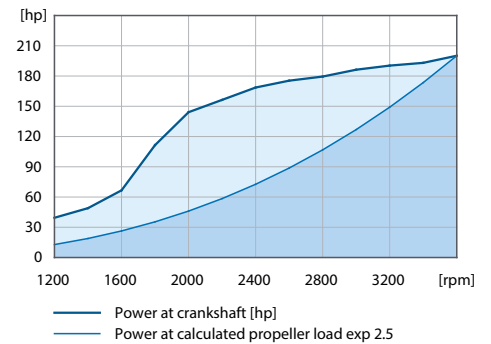

### Torque at crankshaft

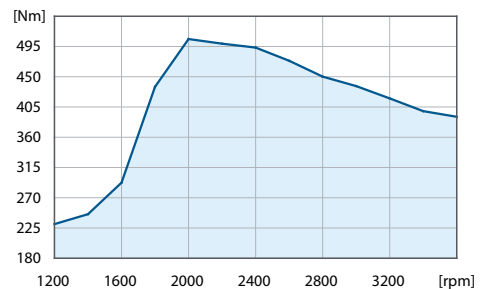

### Fuel consumption

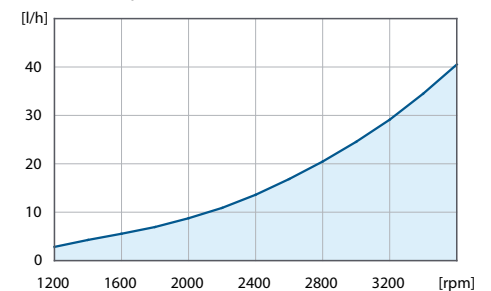

## DIMENSIONS WITH BRAVO X TWO

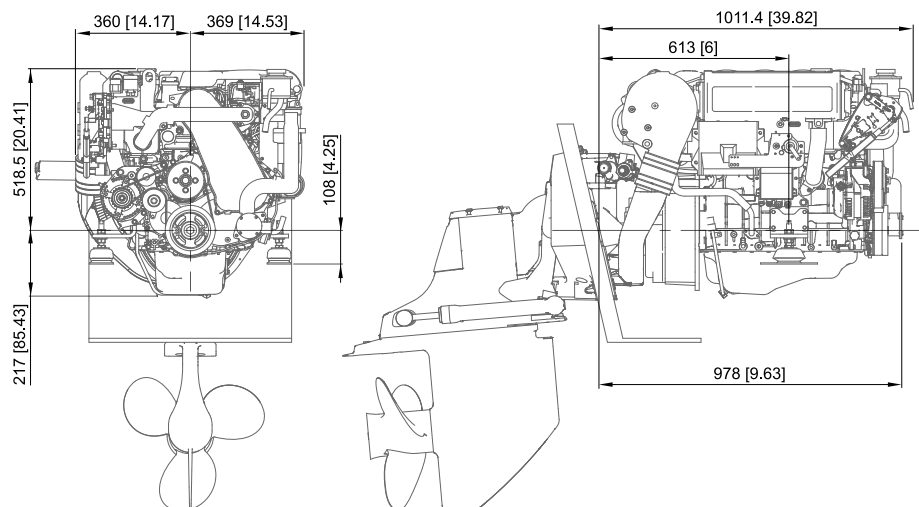

**Nanni Industries S.A.S. France**  
11, Avenue Mariotte - Zone Industrielle  
33260 La Teste - France  
Tel: +33 (0)5 56 22 30 60  
Fax: +33 (0)5 56 22 30 79

**Nanni Trading S.R.L**  
Via Degli Olmetto, 5/B  
00060 Formello (RM) - Italia  
Tel: +39 06 30 88 42 51/52/53  
Fax: +39 06 30 88 42 54

Technical data according to ISO 8665. Specifications are subject to change without notice. Images and illustrations may show non standard equipments. All combination of equipment & accessory are not available.

20160310-A ENG